



B1655





























| | |
|---------------------------|---------------------------|
| Length Overall | 49.40 m (163'7") |
| Beam | 9 m (29'5") |
| Draft | 2.55 m (8'3") |
| Waterline Length | 48.10 m (157'8") |
| Fuel Capacity | 70,000 L (18,492 gallons) |
| Fresh Water Tank Capacity | 12,000 L (3,170 gallons) |
| Holding Tank Capacity | 10,000 L (2,641 gallons) |
| Number of Cabins | 6 Cabins |
| Gross Tonnage | 499 GT |

| | |
|---------------------------|------------------------------|
| Maximum Speed (half load) | 15 Knots |
| Cruise Speed (half load) | 12 Knots |
| Range | 4,000+ nautical miles |
| Displacement at Full Load | 570 m Tons |
| Engines | 2 x Caterpillar C32 /1300 HP |
| Generator System | 2x118 KW / Cat 7. 1 |
| Stabilizer System | ABT-TRAC |
| Bow & Stern Thrusters | ABT-TRAC |
| Steering System | DATA Hydraulic |

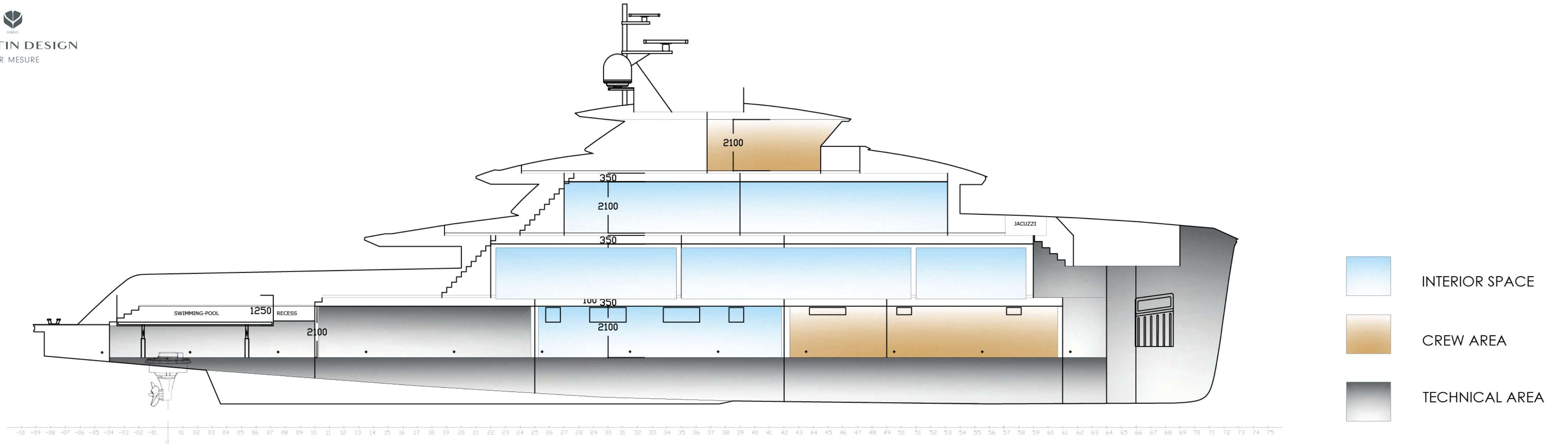

Layouts

Top

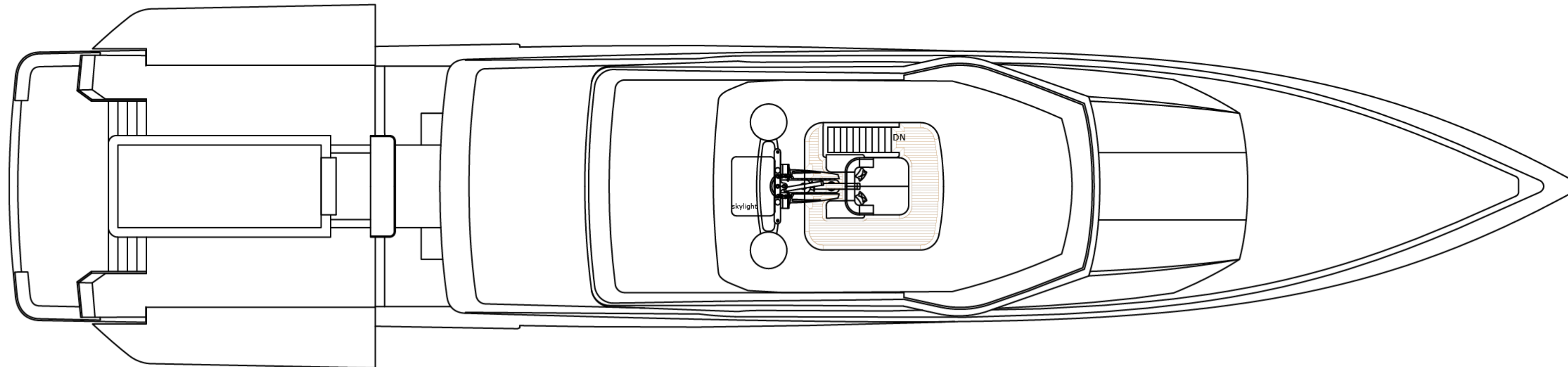

Layouts

Bridge deck

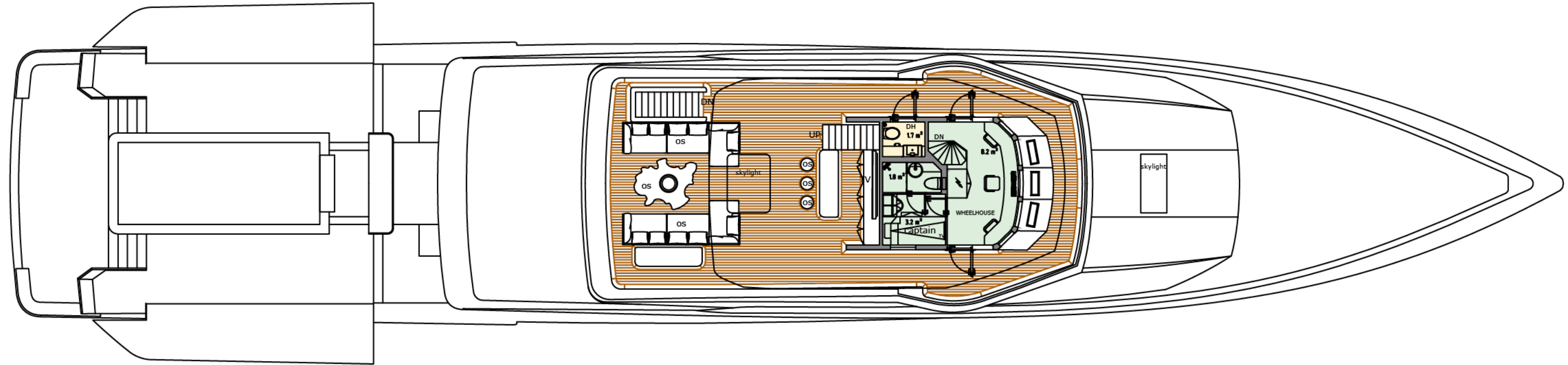

Owner's deck

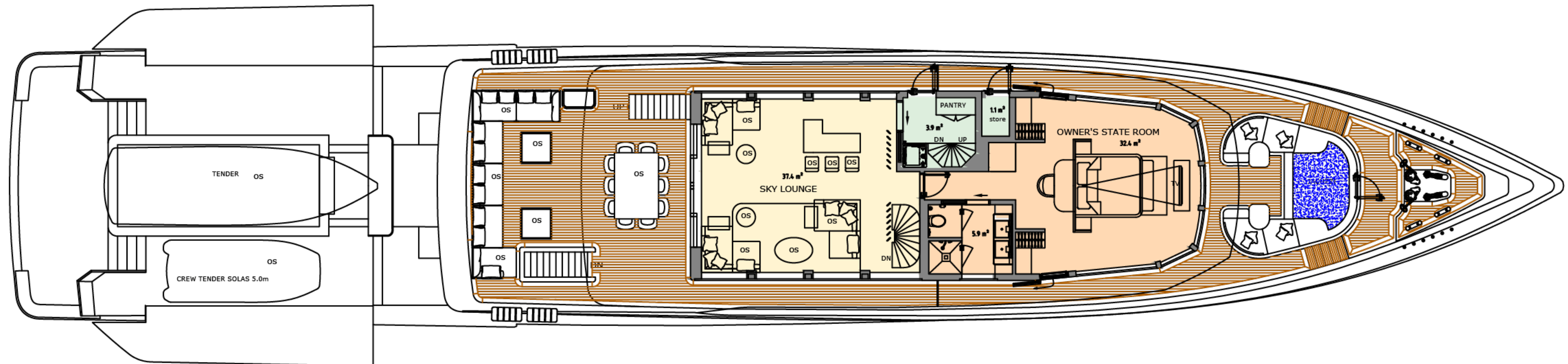

Layouts

Main deck

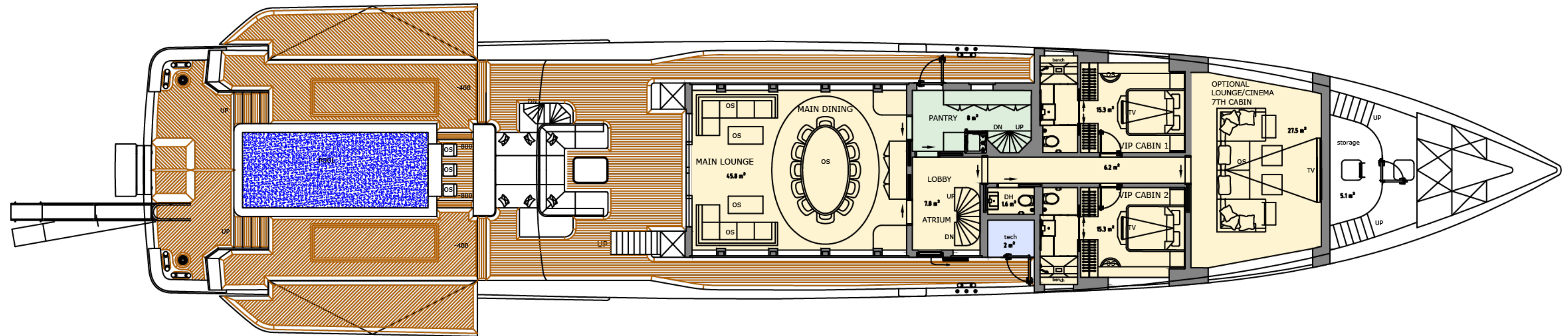

Lower deck

