

  
**BERING**  
YACHTS

**B78**







## Message from the CEO

Starting as a group of enthusiasts, Bering Yachts now is a large operation of passionate professionals. Like a family, we might disagree and argue, but we always remember our goal – give customers their best experience. Passion attracts people.

Owning a boat is a very emotional enterprise. One cannot stay unattached when crossing the deep blue sea. There are so many things to see, so much to experience! That is what we give to our customers – an ability to enjoy every moment of their thrilling rides in comfort and safety.

**Alexey Mikhailov**  
President & CEO

A handwritten signature in blue ink, appearing to read 'Alexey', written in a cursive style.



373

BERING  
YACHTS



## General Description

Bering 78 is an enhanced version of our flagship B70. Her design is based on three years of customer experience with the B70 model, which helped finding areas for improvement and led to the key changes.

We have increased the LOA and the beam by a meter. A wider and longer B78 provides more comfort for guests and crew without compromising the advantages of a sturdy and capable expedition vessel under 24 meters long.





## Interiors

After constructing several B70 hulls, we have developed an improved version within the 70-foot range - B78. Every detail, from the internal design to layout, has been meticulously curated using the most exquisite materials.

Experience the spacious deck with wide side decks thoughtfully designed for effortless line handling and convenient fender placement during docking. A spacious sunbed is located just forward of the pilothouse. Aft, the partially covered cockpit offers ample open space with built-in seating and a teak table for 12 people. With its extended hull, this yacht is an optimal choice for a family or a group of friends eager to share their expedition experiences.



Saloon











Master Stateroom





VIP Guest Stateroom





Guest Stateroom





# BRIEF SPECIFICATION

Length Overall (LOA)	23.85 m / 78'2"
Length Waterline (LWL)	23.55 m / 77'2"
Beam Overall	6.52 m / 21'4"
Draft (with full fuel load)	1.45 m / 4'7"
Displacement Full Load	96.1 metric tons
Gross Tonnage	109 gross tons
Fuel	11.700 L / 3.090 gallons
Fresh Water	2.500 L / 660 gallons
Grey Water	1100 L / 290 gallons
Black Water	1,100 L / 290 gallons
Engines	2 Cummins QSM9 - 335 HP
Cruise Speed	8 knots
Maximum Speed	10 knots
Range at cruise speed	3.000+ nautical miles
Guest	6
Crew	2





Top view

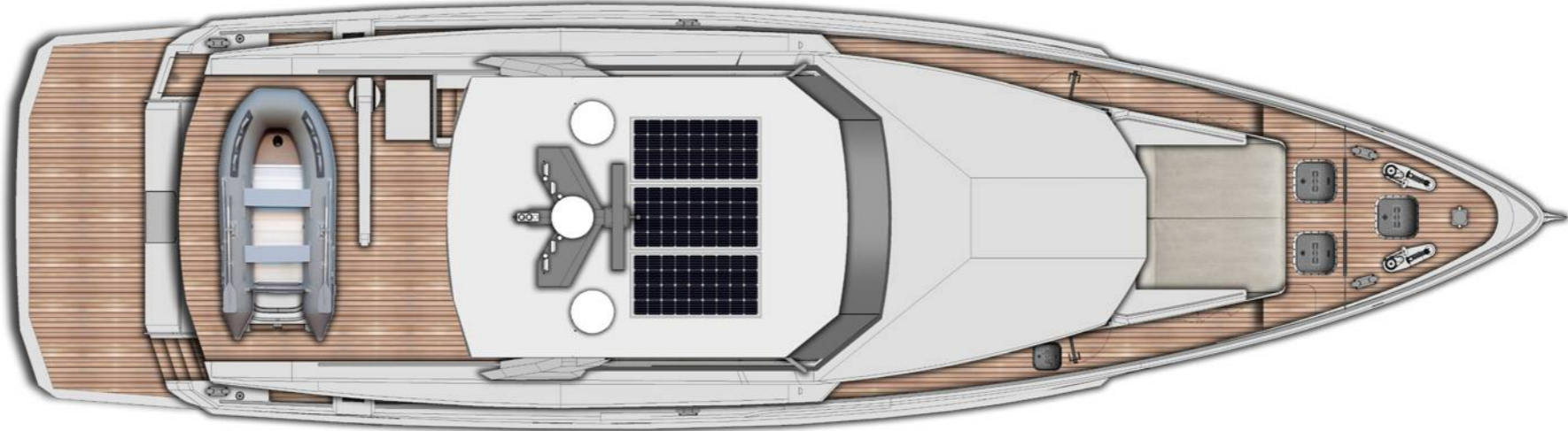

Flybridge

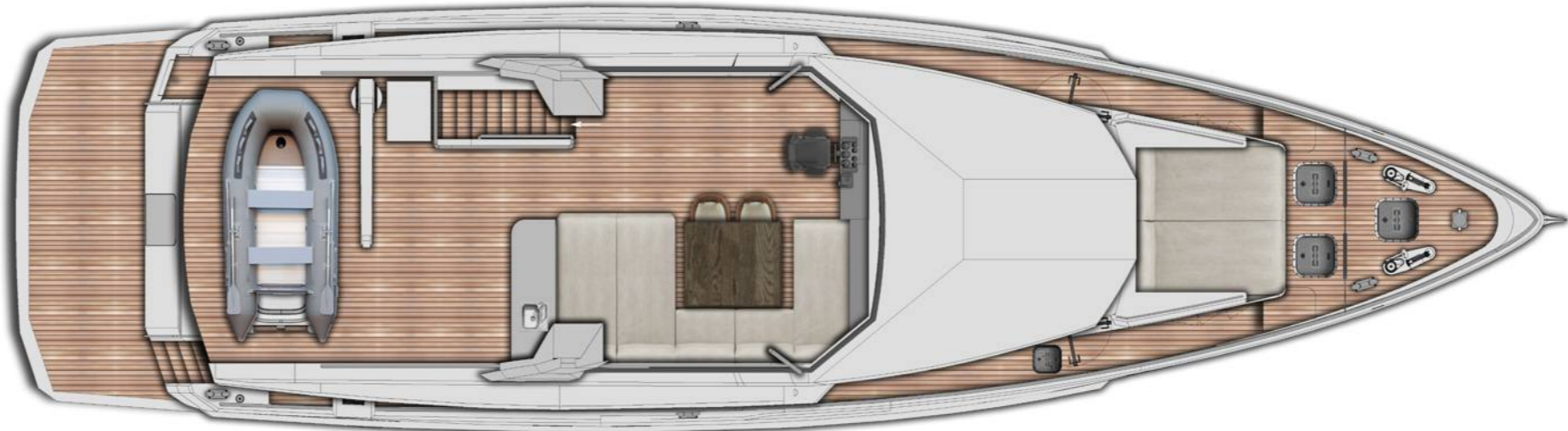

# Option 1: Galley Aft

Main deck

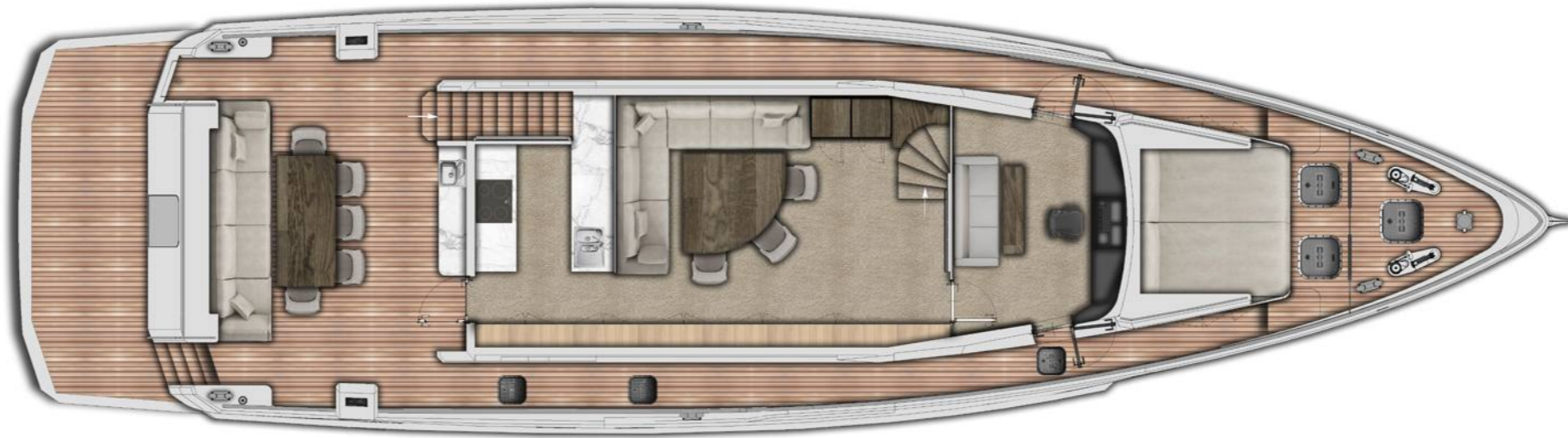

Lower deck



## Option 2: Galley Forward

Main deck



Lower deck



## Bering Yachts in brief

Bering Yachts creates a new caliber of a vessel: recreational steel boat that provides an unequalled level of luxury, capability and safety. Taking design cues from proven oceangoing commercial trawlers, these yachts can cross any ocean comfortably, securely and with a minimal number of stops. We blend comfort and reliability to withstand any forces the nature can bring.

We are special. Being a full production cycle, we develop a concept, manufacture the boat in-house, and then equip it with our own luxury furniture. Bering Yachts satisfy even the most meticulous client, and our customer service truly is second to none.



## Contact us

### **Bering shipyard**

+90 539 826 7008  
contact@beringyachts.com  
Liman Free Trade Zone 07130,  
Antalya, Turkey

### **Americas & the Caribbean**

+1 919 523 4265  
americas@beringyachts.com  
3401 N Miami Ave,  
Suite 224,  
Miami, FL 33127

### **Europe**

+49 1575 1553200  
bogdan@beringyachts.com  
27 Königsallee,  
40212 Düsseldorf, Germany

### **Australia**

+90 541 834 89 26  
sales@beringyachts.com

### **Other regions**

+1 305 797 8497  
contact@beringyachts.com

VISIT OUR WEBSITE





®